

Replacement

NOTE: Take care not to scratch or score the dashboard and use protective tape on the bottom of the front pillar trim.

1. To remove the dashboard, first slide the seats back fully.
2. Remove the console (page 14-49).
3. Remove the steering column (See section 11).
4. Disconnect the dashboard wire harness from the connectors and fuse box.
5. Remove the carpet clips and disconnect the antenna lead.
6. Disconnect the heater control cable and function control cable or cool vent cable (See section 15).
7. Remove the caps on both side and clock.
8. Remove the 7 dashboard mounting bolts.
9. Lift and remove the dashboard.

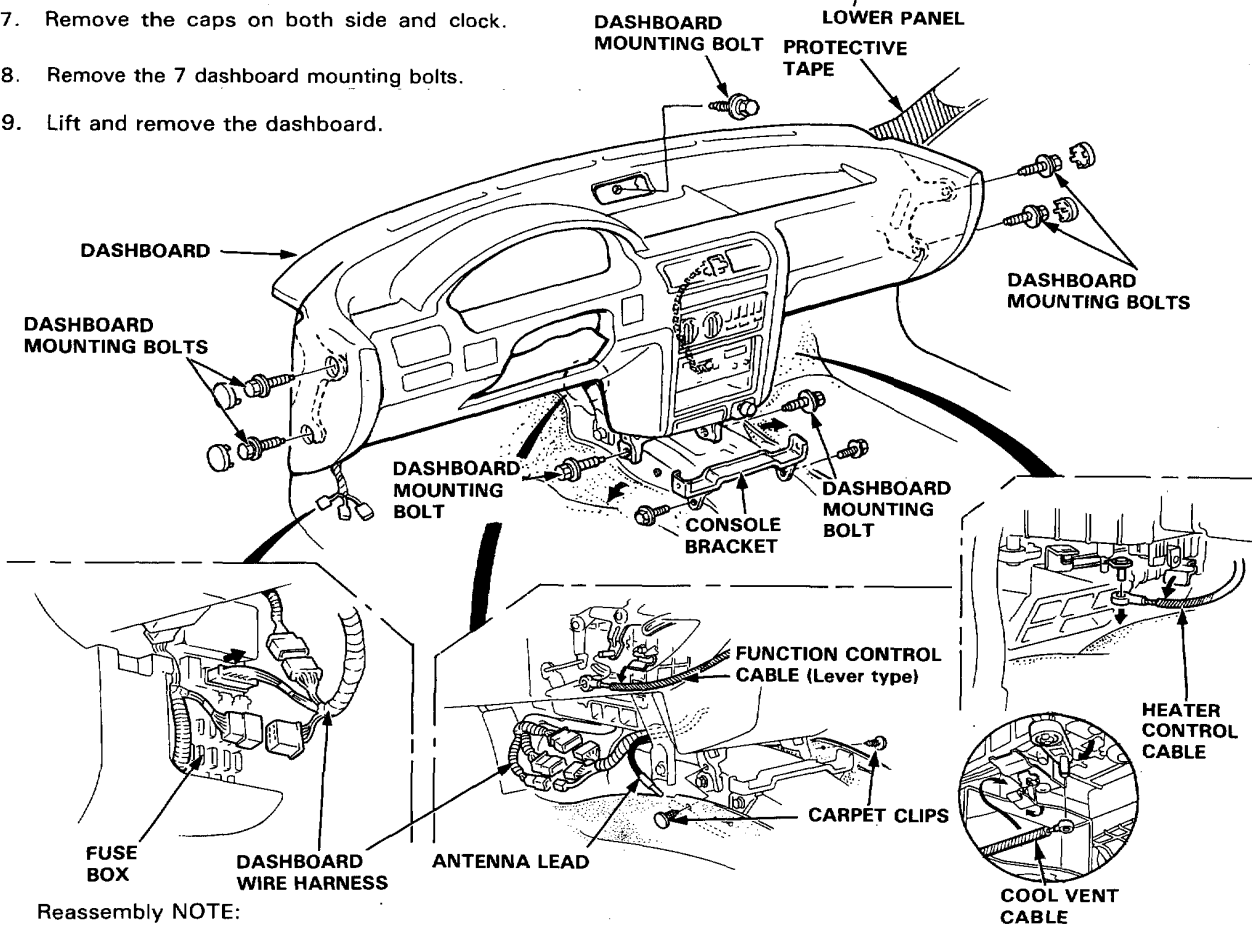
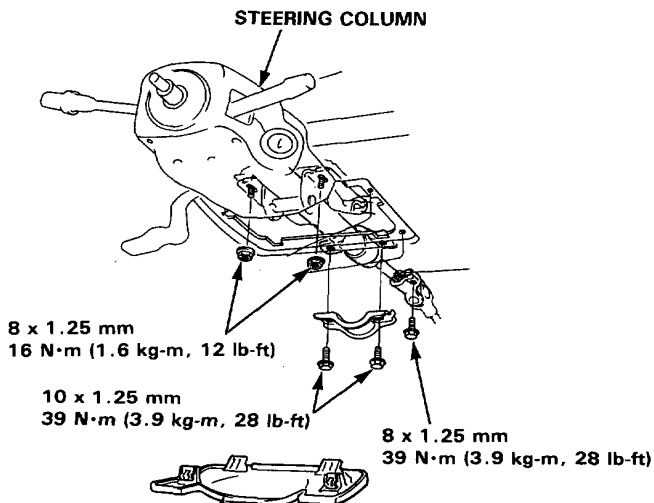

Reassembly NOTE:

- Make sure the dashboard fits onto the body correctly.
- Before tightening the dashboard bolts, make sure the dashboard wires are not pinched, and that the dashboard is not interfering with the heater control and function cables.